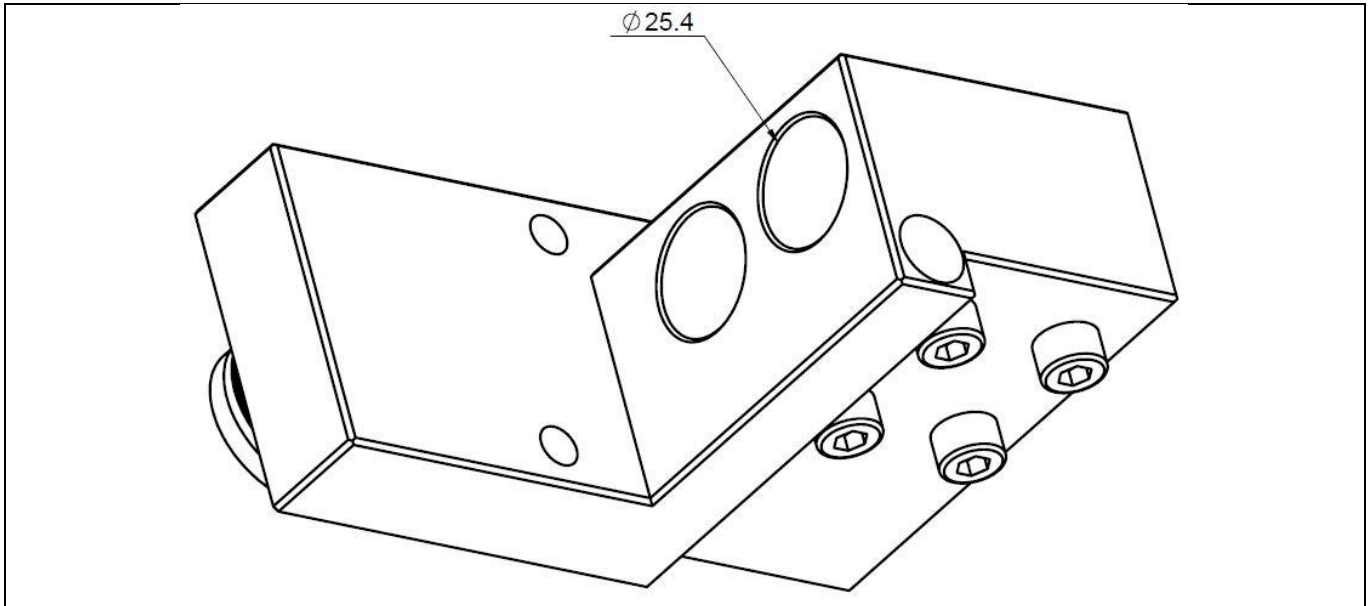
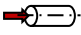
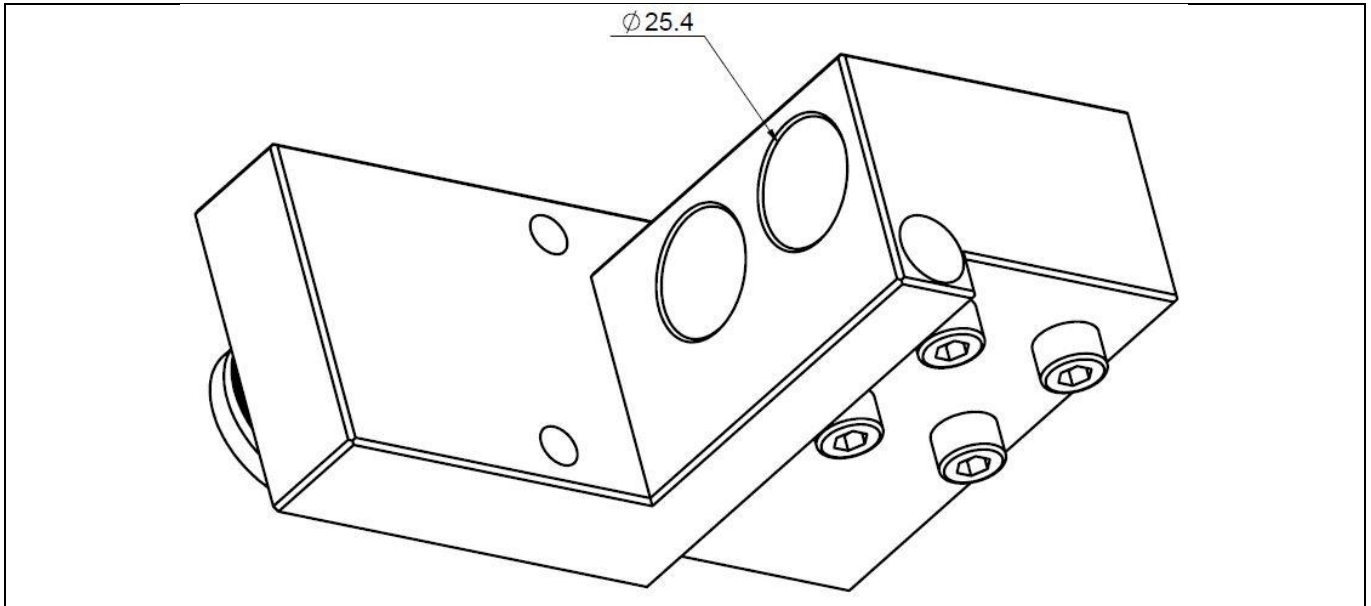
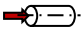
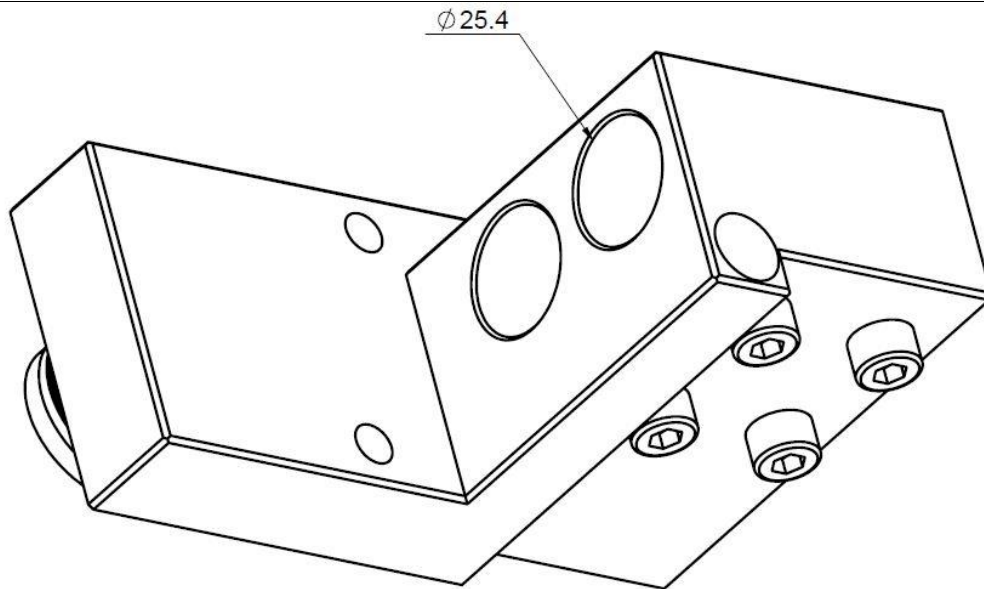

CDF401

Machine: CITIZEN Cincom
Type: M32
Emplacement, N°: Tourelle
Travail sur: Broche principale / Broche de reprise
Type de travail: 
n_{max}: -
i (n_i / n_o): -
Attachement: Ø 25.4 H7
Refroidissement : -
Pression maximale: - [bar]
Infos:

CDF401

Machine: CITIZEN Cincom
Type: M32
Location, N°: Turret
Work on: Main spindle / Back spindle
Type of work: 
n_{max}: -
i (n_i / n_o): -
Attachement: Ø25.4 H7
Coolant: -
Maximum pressure: - [bar]
Infos:

CDF401

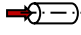
Maschine: CITIZEN Cincom
Typ: M32
Position, N°: Revolver
Arbeit über: Hauptspindel / Abgreifspindel
Arbeitstyp: 
n_{max}: -
i (n_i / n_o): -
Befestigung: Ø25.4 H7
Kühlmittel: -
Maximaler Druck: - [bar]
Infos:

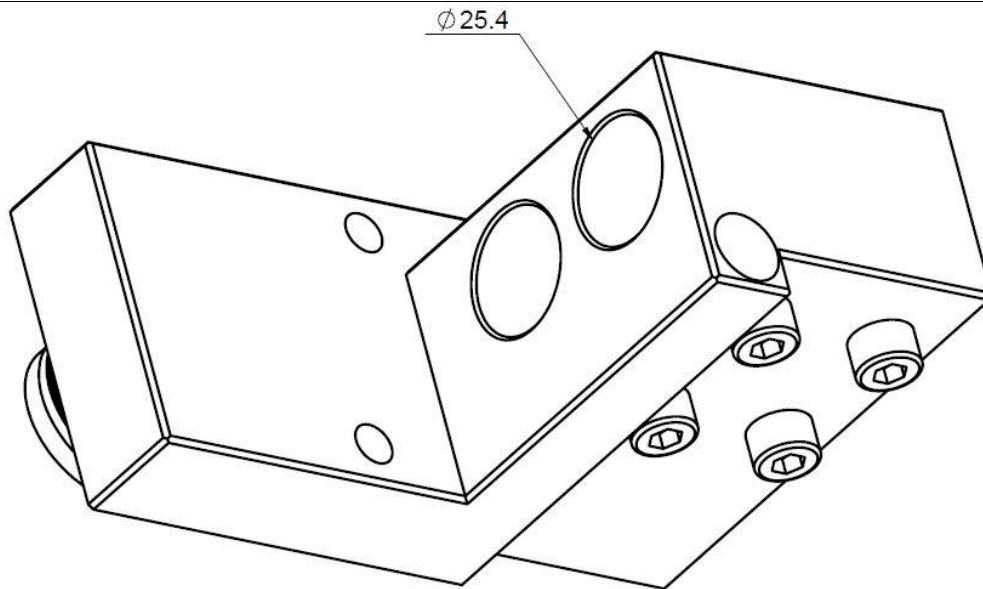
CDF401

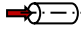
Macchina: CITIZEN Cincom
Tipo: M32
Posizione, N°: Toretta
Lavoro al: Mandrino principale / Contromandrino
Tipo di lavoro: 
n_{max}: -
i (n_i / n_o): -
Ataccamento: Ø25.4 H7
Refrigerante: -
Pressione massima: - [bar]
Informazioni: