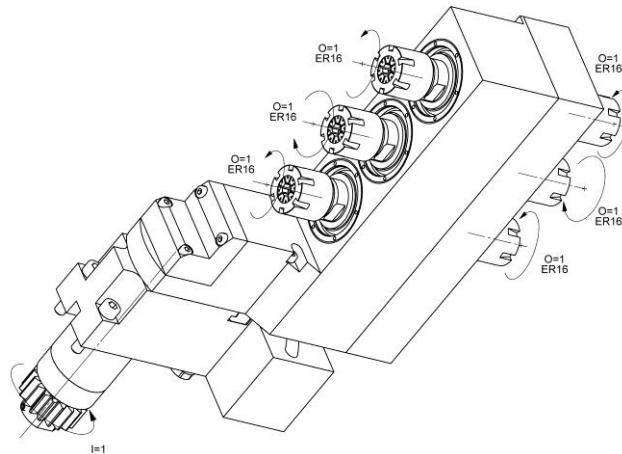

BSA-2010

Machine: CITIZEN Cincom

Type: A320

Emplacement, N°: Coulisse linéaire /T09

Travail sur: Broche principale / Broche de reprise

Type de travail: n_{max}: 8'000 [rpm]i (n_i / n_o): 1 / 1

Attachement: ER 16

Sans refroidissement

Infos:

- Inclinaison maximale => 0°-21°
- Attention ! Risque de collision avec unité d'usinage de reprise U153B. Unité à enlever ou remplacer par autres système équivalent.

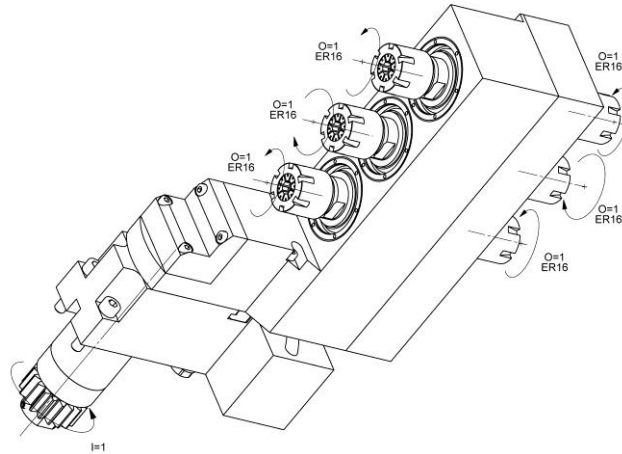
BSA-2010

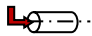
Machine: CITIZEN Cincom
Type: A320
Location, N°: Gangtool / T09
Work on: Main spindle / Back spindle
Type of work: 
n_{max}: 8'000 [rpm]
i (n_i / n_o): 1 / 1
Attachement: ER 16
Without coolant

Infos:

- Maximal Slope = > 0°-21 °
- Watch out! Risk of collision with unit U153B. Unit to remove or to replace by other equivalent system.

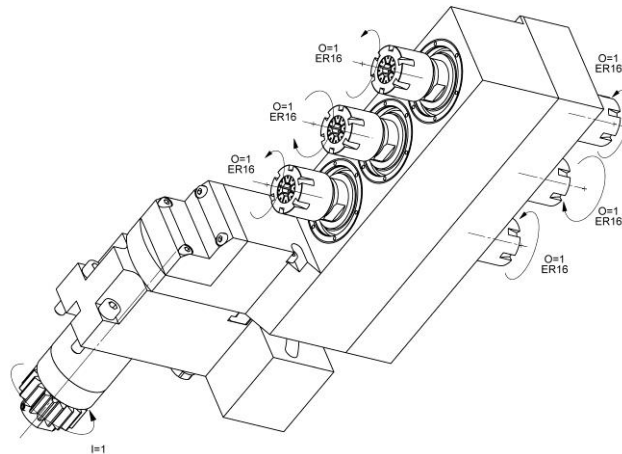
BSA-2010

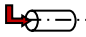
Maschine: CITIZEN Cincom
Typ: A320
Position, N°: Vertikalhalter / T09
Arbeit über: Hauptspindel / Abgreifspindel
Arbeitstyp: 
n_{max}: 8'000 [rpm]
i (n_i / n_o): 1 / 1
Befestigung: ER 16

Ohne Kühlmittel

Infos:

- Maximale Neigung => 0°-21 °
- Achtung! Kollisionsgefahr mit U153B Wiederaufnahme der Fräseinheit. Einheit entfernt oder durch andere äquivalente System ersetzt.

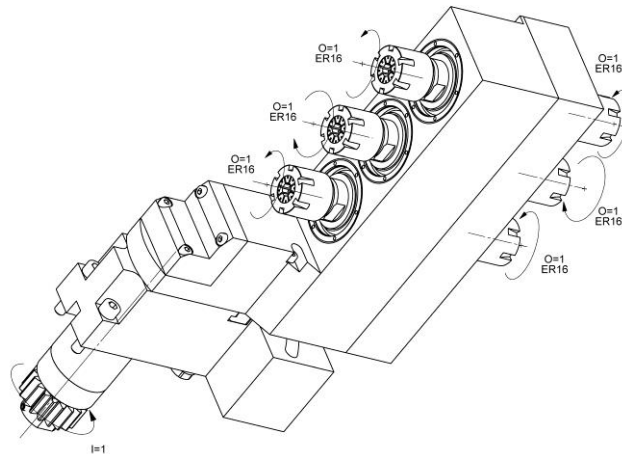
BSA-2010

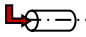
Macchina: CITIZEN Cincom
Tipo: A320
Posizione, N°: Slitta lineare / T09
Lavoro al: Mandrino principale / Contromandrino
Tipo di lavoro: 
 n_{max} : 8'000 [rpm]
 i (n_i / n_o): 1 / 1
Ataccamento: ER 16

Senza refrigerante

Informazioni:

- Inclinazione massima => 0°-21 °
- Attenzione! Rischio di collisione con U153B ripresa delle unità di fresatura. Unità rimosso o sostituito con altro sistema equivalente.