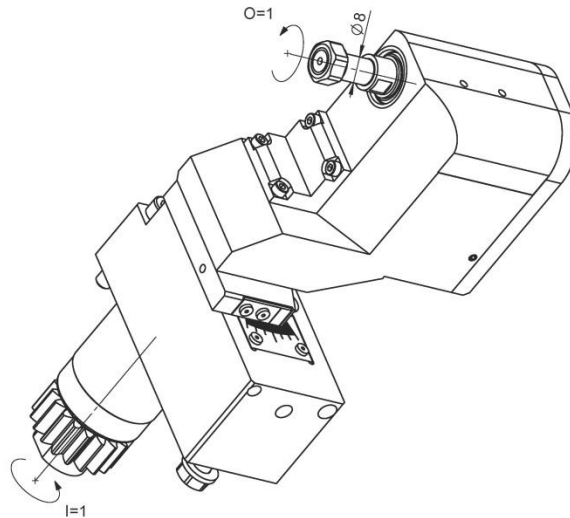

CITIZEN6-LSH-180

Machine: CITIZEN

Type: L220/ L32

Emplacement, N°: Coulisse linéaire

Travail sur: Broche principale

Type de travail:  n_{max} : 5'000 [rpm] $i (n_i / n_o)$: 1 / 1

Attachement: Arbre Ø8mm

Sans refroidissement

Infos:

Fraise Ø8/18 x 12 : inclinaison possible -2°...+15°

Fraise Ø8/24 x 12 : inclinaison possible -2°...+4°

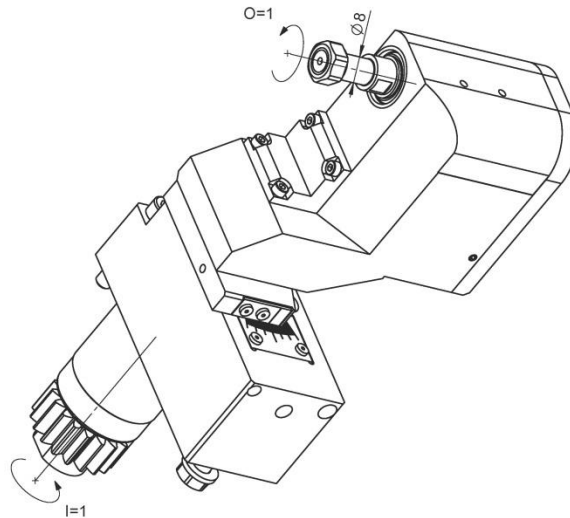
CITIZEN6-LSH-180

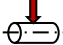
Machine: CITIZEN
Type: L220/ L32
Location, N°: Gangtool
Work on: Main spindle
Type of work: 
 n_{max} : 5'000 [rpm]
 $i (n_i / n_o)$: 1 / 1
Attachement: Shaft Ø8mm

Without coolant

Infos:

Mill Ø8/18 x 12 : inclination $-2^\circ \dots +15^\circ$

Mill Ø8/24 x 12 : inclination $-2^\circ \dots +4^\circ$

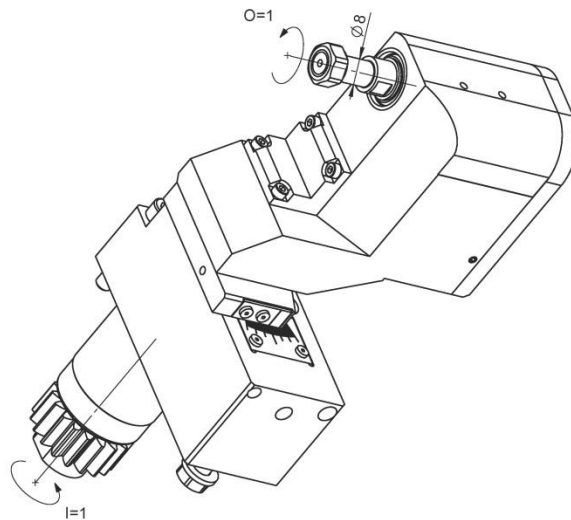
CITIZEN6-LSH-180

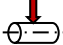
Maschine: CITIZEN
Typ: L220/ L32
Position, N°: Vertikalhalter
Arbeit über: Hauptspindel
Arbeitstyp: 
 n_{max} : 5'000 [rpm]
 $i (n_i / n_o)$: 1 / 1
Befestigung: Schaft Ø8mm

Ohne Kühlmittel

Infos:

Fräser Ø8/18 x 12 : Neigungswinkel -2°...+15°

Fräser Ø8/24 x 12 : Neigungswinkel -2°...+4°

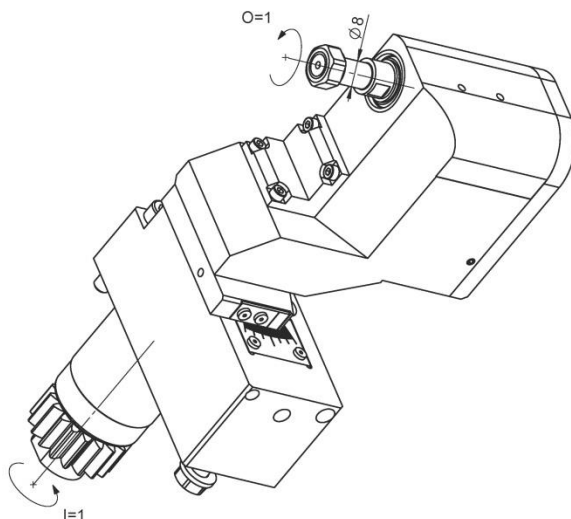
CITIZEN6-LSH-180

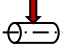
Macchina: CITIZEN
Tipo: L220/ L32
Posizione, N°: Slitta lineare
Lavoro al: Mandrino principale
Tipo di lavoro: 
 n_{max} : 5'000 [rpm]
 $i (n_i / n_o)$: 1 / 1
Ataccamento: Codolo Ø8mm

Senza refrigerante

Informazioni:

Frese Ø8/18 x 12 : inclinazione -2°...+15°

Frese Ø8/24 x 12 : inclinazione -2°...+4°