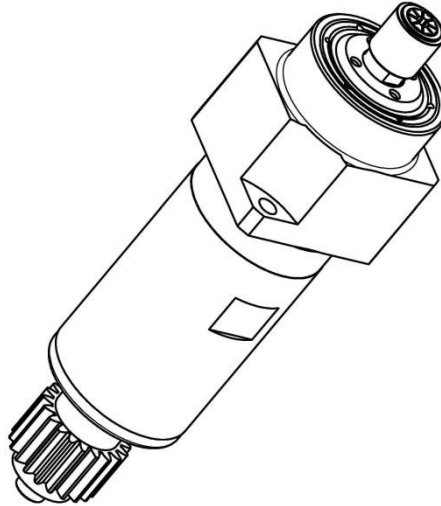

**BW20-GSC-105-4x**

Machine: TSUGAMI

Type: BW207 – BW208 – BE208Z – BW209Z

Emplacement, N°: Front gang tool post / Back gang tool post

Travail sur: Broche principale

Type de travail: n<sub>max</sub>: 30'400 [rpm]i (n<sub>i</sub> / n<sub>o</sub>): 1 / 3.8

Attachement: ER8

Sans refroidissement

Infos:

Couple max : 0.2 Nm

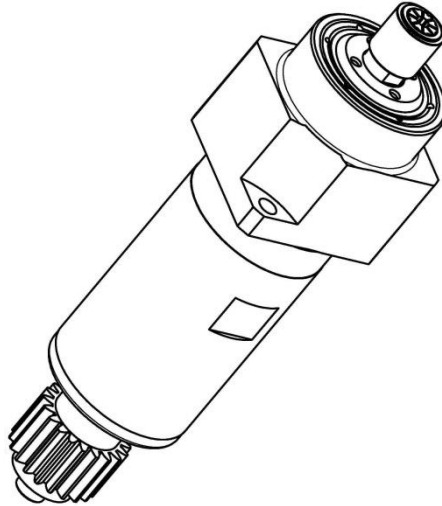
**BW20-GSC-105-4x**

Machine:	TSUGAMI
Type:	BW207 – BW208 – BE208Z – BW209Z
Location, N°:	Front gang tool post / Back gang tool post
Work on:	Main spindle
Type of work:	
$n_{max}$ :	30'400 [rpm]
$i$ ( $n_i$ / $n_o$ ):	1 / 3.8
Attachement:	ER 8
Without coolant	
Infos:	
Torque max: 0.2 Nm	

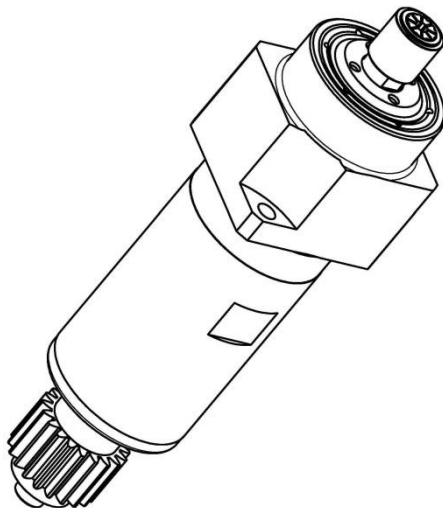
**BW20-GSC-105-4x**

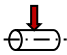
Maschine:	TSUGAMI
Typ:	BW207 – BW208 – BE208Z – BW209Z
Position, N°:	Front gang tool post / Back gang tool post
Arbeit über:	Hauptspindel
Arbeitstyp:	
$n_{max}$ :	30'400 [rpm]
$i$ ( $n_i$ / $n_o$ ):	1 / 3.8
Befestigung:	ER 8
Ohne Kühlmittel	
Infos:	
Max. Drehmoment: 0.2 Nm	

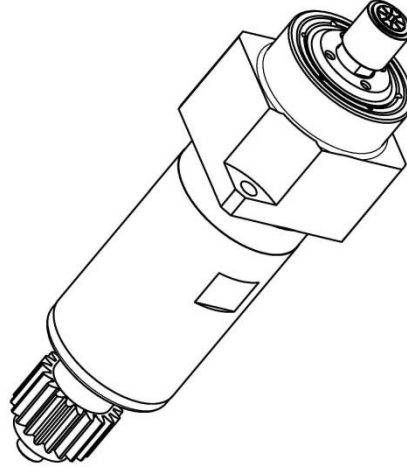
**BW20-GSC-105-4x**

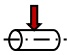
Macchina: TSUGAMI  
Tipo: BW207 – BW208 – BE208Z – BW209Z  
Posizione, N°: Front gang tool post / Back gang tool post  
Lavoro al: Mandrino principale  
Tipo di lavoro:   
 $n_{max}$ : 30'400 [rpm]  
 $i$  ( $n_i$  /  $n_o$ ): 1 / 3.8  
Atacco: ER 8  
Senza refrigerante  
Informazioni:  
Coppia max: 0.2 Nm