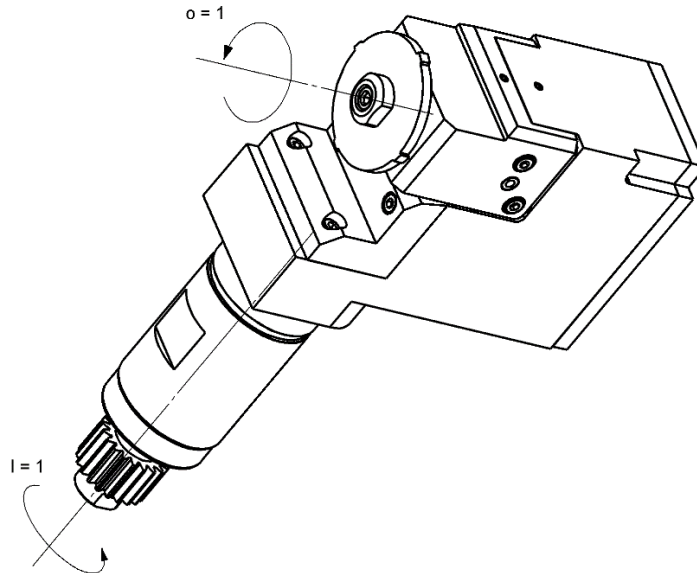
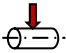

0400-SF080-RA0000-1S01

Machine: TSUGAMI
Type: BW207-209 / Z
Emplacement, N°: Back gang tool post
Travail sur: Broche principale
Type de travail: 
i (n_i / n_o): 1 / 1
Attachement: Arbre Ø 8

Sans refroidissement

Infos:

- Diamètre de la fraise. : Ø 45mm max.
- Epaisseur de la fraise : 3-5mm max.
- Polygoneur pour filetage extérieur uniquement.
- Ligne de coupe à 1mm de la broche.
- Inclinaison de la tête : 0...1.5°

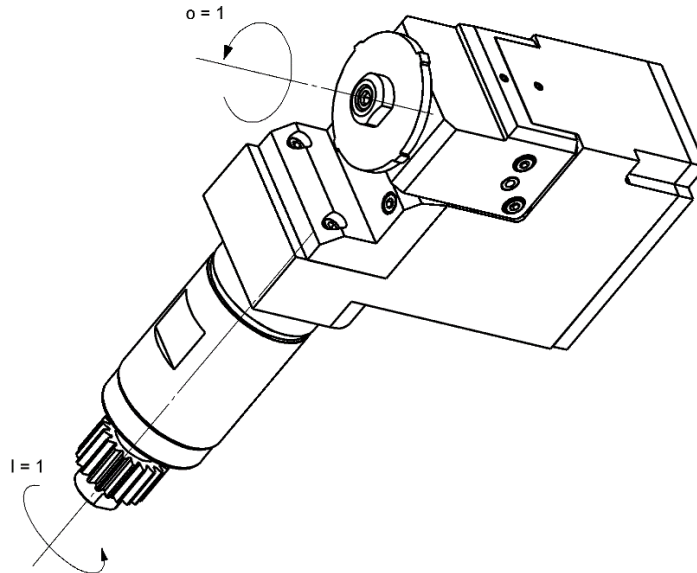
0400-SF080-RA0000-1S01

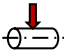
Machine: TSUGAMI
Type: BW207-209 / Z
Location, N°: Back gang tool post
Work on: Main spindle
Type of work: 
i (n_i / n_o): 1 / 1
Attachement: Arbor Ø 8

Without coolant

Infos:

- Diameter of the mill : Ø45mm max.
- Width of mill cutter : 3-5mm max.
- Driven toolholder for thread milling only.
- Line of cutting in 1mm of the spindle
- Slope 0... 1.5°

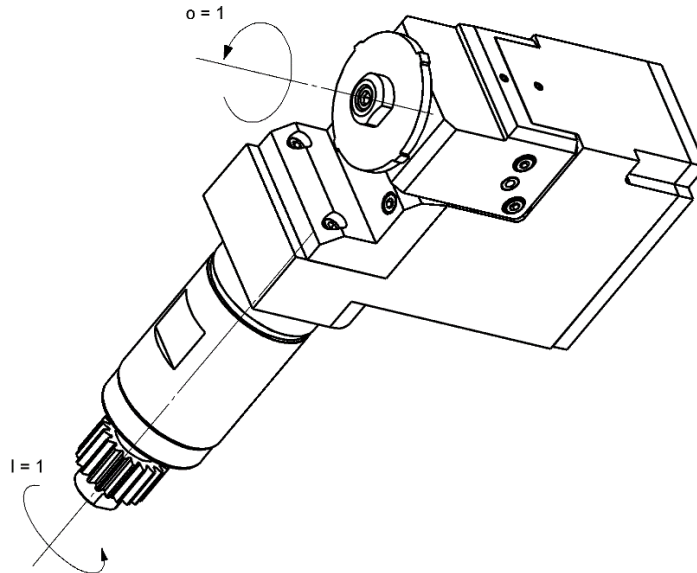
0400-SF080-RA0000-1S01

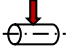
Maschine: TSUGAMI
Typ: BW207-209 / Z
Position, N°: Back gang tool post
Arbeit über: Hauptspindel
Arbeitstyp: 
i (n_i / n_o): 1 / 1
Befestigung: Welle Ø 8

Ohne Kühlmittel

Infos:

- Fräserdurchmesser : Ø45mm max.
- Breite des Fräasers : 3-5mm max.
- Angetriebener Werkzeughalter nur zum Gewindefräsen.
- Schnittlinie bis 1 mm von der Spindel.
- Neigungswinkel 0...1.5°